

# easyCounter

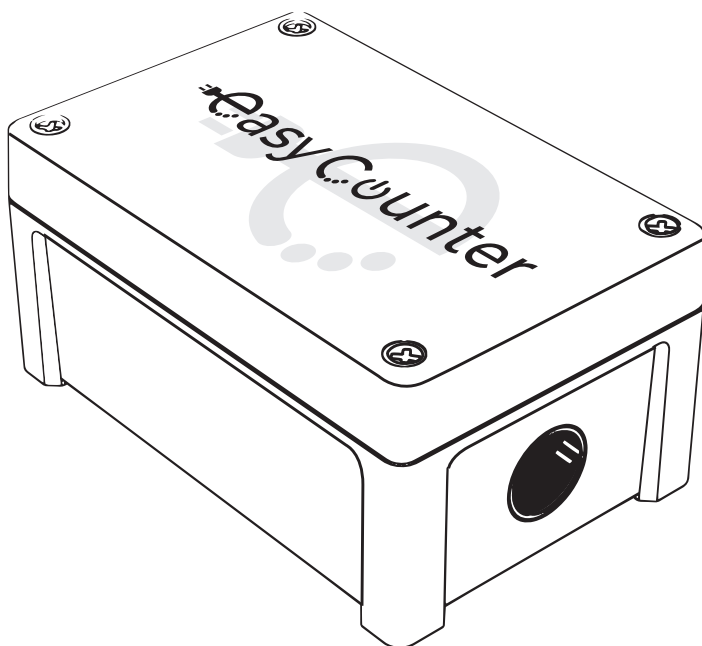

## INSTALLATION, USE AND MAINTENANCE MANUAL

GB



## INDEX

SECTION	PAGE
<b>1. ABOUT THE INSTALLER MANUAL</b>	<b>50</b>
1.1. About installation	51
1.2. Symbols used	51
1.3. Warnings	52
<b>2. SAFETY</b>	<b>54</b>
2.1. Intended purpose of <b>easyCounter</b>	54
2.2. Use not in accordance with the intended purpose	54
2.3. Essential safety instructions	55
2.3.1. Respect for local conditions	55
2.3.2. Respecting the supervision requirement	55
2.3.3. Regulatory status	55
<b>3. PRODUCT DESCRIPTION</b>	<b>56</b>
3.1. General description	56
3.2. Identification label	58
3.3. Technical features	59
<b>4. INSTALLATION</b>	<b>60</b>
4.1. Choice of position	60
4.2. Acceptable environmental conditions	61
4.3. What's inside	62
4.4. Finding the correct electrical line	64
4.5. Wall mounting	65
4.6. Connecting the power supply cables	69
4.6.1. SITUATION A: Wiring between <b>easyCounter</b> and <b>easyWallbox</b> installed in Power Upgrade mode	70
4.6.2. SITUATION B: Wiring between <b>easyCounter</b> and <b>easyWallbox</b> installed in Plug & Play mode	72
4.6.3. Connection to the electrical system	74

## INDEX

SECTION	PAGE
4.6.4. Activating the Bluetooth gateway	76
4.6.5. Re-assembling the device	78
<b>5. FIRST START</b>	<b>79</b>
5.1. Turning on <b>easyCounter</b>	79
5.2. Connection via the My <b>easyWallbox</b> app (specifically for the end user)	80
5.3. Reading consumption data	81
<b>6. MAINTENANCE</b>	<b>82</b>
6.1. Replacing the gateway battery	83
<b>7. DISMANTLING AND STORAGE</b>	<b>86</b>
7.1. Disconnection from the power supply	86
7.2. Removal of the device from the wall	86
7.3. Storage	90
<b>8. DISPOSAL</b>	<b>90</b>
8.1. Disposal of the packaging	90
8.2. Taking out of service and disposal of <b>easyCounter</b>	90
<b>9. ASSISTANCE</b>	<b>91</b>
<b>DISCLAIMER</b>	<b>92</b>

## 1. ABOUT THE INSTALLER MANUAL

Thank you for choosing **easyCounter**. Please take a few minutes to read the documentation that will enable you to install it and use it safely, discovering all its advantages.

**easyCounter** is an energy meter certified up to 7.4 kW single phase with permanent connection to the domestic electrical system. It is a device that measures and collects electricity consumption data during each domestic charging session carried out with **easyWallbox**. The information in this **Installer's Manual** is intended for the **easyCounter** installer and user and **concerns installation**, safe use and the maintenance of this apparatus.



**Read the associated documentation carefully to acquire familiarity with the instructions and safety indications before installing the product.**



**As a permanent connection to the domestic electrical system is required, installation must be carried out by personnel qualified for the design and creation of a dedicated, state of the art, electrical system and certification of the domestic electrical system in compliance with local regulations and the energy supply contract.**



**easyCounter can only be used in association with easyWallbox.**



**The data shown may differ from that in the Figures, depending on the version of the product.**

### 1.1. About installation

The installation requires a permanent connection to the electricity network; therefore, qualified personnel are required who are authorised to create and certify electrical systems in compliance with local regulations and the energy supply contract.



**Installation of the product must be carried out following carefully the instructions in this manual.**



**We advise contacting Assistance for any question or doubt on the use, installation and maintenance of easyCounter (see Chapter 9 Assistance).**

### 1.2. Symbols used



**DANGER**

This symbol indicates imminent danger causing death or serious injuries.



**WARNING**

This symbol indicates a dangerous situation that may cause death or serious injuries.



**CAUTION**

This symbol indicates a dangerous situation that may cause slight injuries.



**ATTENTION**

This symbol indicates a situation that may cause material damage to **easyCounter**.



**QUALIFIED PERSONNEL**

Work that must be carried out by a technician, hereinafter 'Qualified Personnel', authorised to create and certify electrical systems in compliance with local regulations and the energy supply contract.

### 1.3. Warnings



#### Danger of electric shock and fire

- Before using **easyCounter**, **read the contents** of this manual carefully to acquire familiarity with the instructions for use and the safety indications.
- Before starting installation, ensure that **easyCounter** and **easyWallbox** **are not connected to any power supply**. Any installation, maintenance and dismantling operation should only be done when disconnected from the power supply.
- Before installing or using the device, **make sure that no damage has occurred to any component**. Damaged components can lead to electrocution, short circuits, and fire due to overheating. A device with damage or defects must not be used.
- Install **easyCounter** away from petrol cans or combustible substances in general.
- **Before carrying out any maintenance** operation, ensure that the power supply is off.
- Before connection to the electrical system, ensure that **wiring has been done correctly** with the correct earthing connection and in compliance with local and international standards and all the technical requirements indicated in this manual.
- Before putting back or moving **easyCounter**, ensure that the device is not attached to the power supply.
- Use of **easyCounter** must be limited to the specific applications it is intended for.
- Installation, maintenance or repairs not made correctly may lead to risks for the user. Please ensure that **easyCounter** is only used in the correct operating conditions.
- The apparatus must be connected to an electricity network in compliance with local and international standards and all the technical requisites indicated in this manual.
- **Children** or other persons not able to evaluate risks related to the installation or use of the device might be **seriously injured or risk their own lives**. Such persons must not operate the device and must be supervised when close to it.
- Pets or other animals must be kept away from the device and packaging material.
- **Children must not play with the device**, the accessories or the packaging provided with the product.
- **The front cover is the only part that can be removed from easyCounter**, and only during installation and maintenance, following the instructions. **easyCounter** must not be opened for any other reason.
- **easyCounter** can only be used combined with an energy source.
- **easyCounter must be treated and disposed of** as electric and electronic waste (WEEE) **in compliance with current legislation**, separately from normal household waste.



**Always switch off power before carrying out any maintenance. Before installing easyCounter, make sure that the main power supply used is switched off on the electrical switchboard.**

## 2. SAFETY

### 2.1. Intended purpose of easyCounter

**easyCounter** is only intended for **fixed mounting**. It can only be installed and used in association with **easyWallbox** in both indoor and outdoor areas to monitor consumption during the charging of electric vehicles in compliance with the indications of Chapter 4 and local regulations. **easyCounter** is environmentally classified as having Type B electromagnetic compatibility (EMC). Unless otherwise indicated, all the instructions in this Installer's Manual are intended to be carried out only by qualified personnel with the skills described in Chapter 1.3.



**The installation should comply with local installation regulations.**

### 2.2. Use not in accordance with the intended purpose

Use of **easyCounter** is only safe if it conforms to the intended purpose. Different use and unauthorised modifications to the device are considered as non-compliant and so unacceptable. The user is responsible for the use and is liable for any dangerous situations or situations contrary to the legal provisions applied in their country.



**Free2Move eSolutions does not assume any liability for damage caused by non-compliant use or unauthorised modifications to the device.**

### 2.3. Essential safety instructions

**easyCounter** has been designed, built and tested in compliance with the current safety laws. Installation must only be done by qualified personnel, able to understand and follow these instructions carefully, and know all the associated risks. Free2Move eSolutions does not assume any liability for damage to persons or things that may arise from failure to respect the safety regulations and the instructions in this manual.

#### 2.3.1. Respect for local conditions

The operational safety of **easyCounter** depends on its correct installation which must respect current legislation.



**Incorrect installation may cause danger such as serious injury or death.**

#### 2.3.2. Respecting the supervision requirement



Children and people not able to evaluate, even momentarily, the possible risks arising from the incorrect use of **easyCounter** must be kept away from the device, both when in use and non-operational.

#### 2.3.3. Regulatory status

**easyCounter** must be maintained intact. If there is any damage or defect, users run the risk of serious injury caused by electric shocks. Therefore, the instructions below must be followed:

- avoid knocking the device
- avoid use not in accordance with the intended purpose
- avoid incorrect use of the device
- clearly indicate the malfunction of the device so that other people will not use it
- in the event of a fault, call qualified personnel promptly so that the device can be taken out of service.

### 3. PRODUCT DESCRIPTION

#### 3.1. General description

**easyCounter** is a device that measures and makes available the electricity consumption of **easyWallbox** for power up to 7.4 kW and 32 A single phase. By integrating Bluetooth connectivity, it ensures fast, simple reading and data transmission to the eCommerce platform for users who have subscribed to the recharge service offered by Free2Move eSolutions.

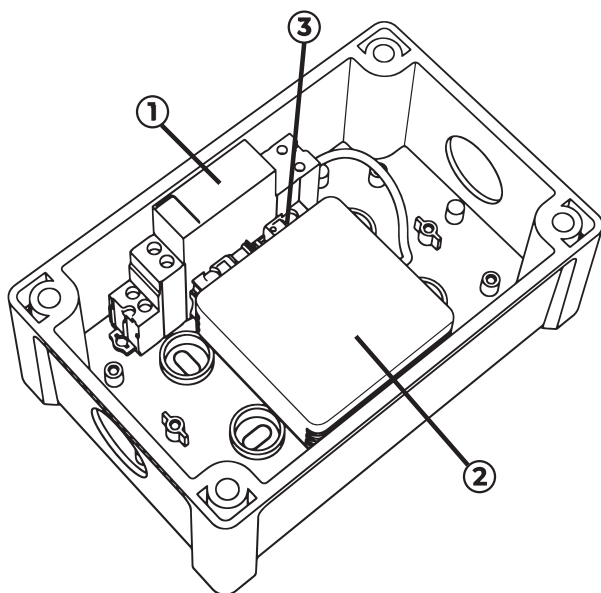

#### Product description

- ① Energy meter
- ② Gateway Bluetooth
- ③ Earth terminal

#### Product size

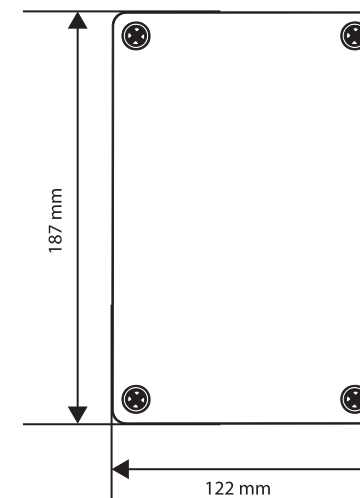

front view

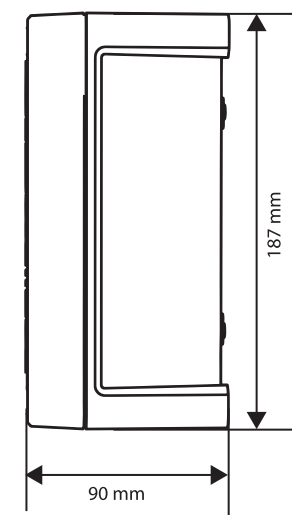

side view

### 3.2. Identification label

The identification label is on the inside of the front cover of **easyCounter**. The information on the label is shown in the Figure below. The model code and serial number are also found on the packaging as well as in the My **easyWallbox** app after authentication. The data shown may differ from that in the Figure, depending on the version of the product.

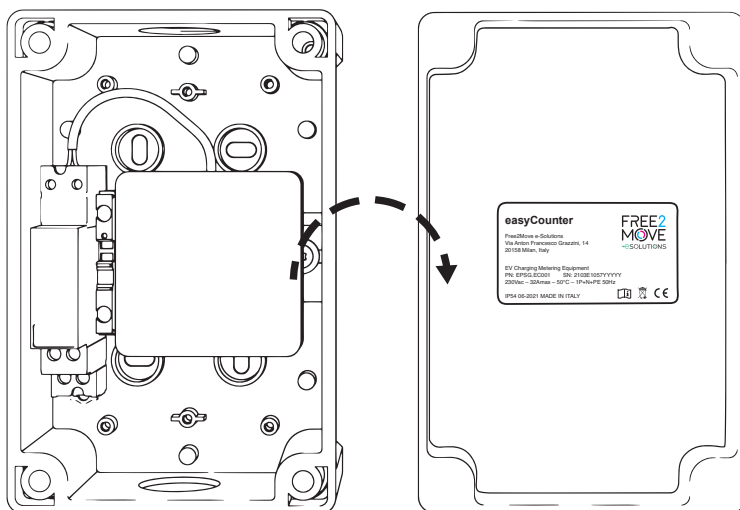

### 3.3. Technical features

#### General specifications

Enclosure ratings	IP54 (IEC 60529)
Housing	Polycarbonate
Overall body dimensions [mm]	122 x 187 x 90
Weight [kg]	~ 0,5

#### Electrical specifications

Maximum Power [kW]	Up to 7.4
Voltage [V / Hz]	230 / 50, Single-phase
Current [A]	Up to 32
Power absorbed [W]	≤ 0.5
Gateway power supply	3.6 V AA battery, included

#### Safety and Operation

Temperature range [°C]	-25 ÷ 50
Housing fire ratings	UL 746C 5"
Maximum installation height [m]	2000 a.s.l.
Mounting	Wall

#### Connectivity and advanced features

Bluetooth	Yes
Smartphone APP	My easyWallbox, compatible with Android Lollipop and above, iOS 12 and above
Communication standard	Bluetooth Low Energy

## 4. INSTALLATION

### 4.1. Choice of position

**easyCounter** has been designed for use both indoors and outdoors in compliance with the indications in this Chapter and local regulations. It is only intended for fixed wall mounting; in addition, it must be installed in the same room as **easyWallbox** to ensure the correct operation of Bluetooth on the device.

Before installing the device, check the feasibility. In detail, **easyCounter** must be installed:

- on a vertical and flat surface; weak surfaces that do not ensure robustness must be avoided
- on an area without material or equipment on the whole of the surface required for the installation
- so that simple connection to the electrical system can be ensured
- respecting local legislation on electrical installations, fire prevention measures and emergency exits in the installation site.

**easyCounter** must not be installed:

- on walls that are not fixed;
- on walls in inflammable material or covered in inflammable material (e.g. wood, carpet, etc.).

In addition, it must not be installed in places:

- at risk of explosion (EX environment)
- used for escape routes
- where articles may fall on it (e.g. suspended ladders or car tyres) or where it is likely to be hit and damaged (e.g. close to a door or in vehicle operating spaces)
- where there is a risk of pressurised jets of water (e.g. because of washing systems, power washers or garden hoses).

### 4.2. Acceptable environmental conditions

In detail, the conditions of the room where **easyCounter** is sited must be as follows:

- room temperature between -25°C and +50°C
- average temperature over 24 hrs less than 35°C
- maximum altitude above sea level: 2,000 metres
- relative air humidity not higher than 95%.



**Damage to easyCounter caused by unsuitable environmental conditions. Inappropriate positioning of easyCounter may cause damage to the device.**

The following indications must be followed when choosing the position to install **easyCounter**:

- avoid exposure to direct sunlight
- avoid direct exposure to the rain so that deterioration due to bad weather does not occur
- ensure sufficient ventilation for the device – do not mount it inside a niche or cupboard
- avoid an accumulation of heat - keep the device away from heat sources
- avoid exposure to water infiltration
- avoid excessive jumps in temperature.



### 4.3. What's inside

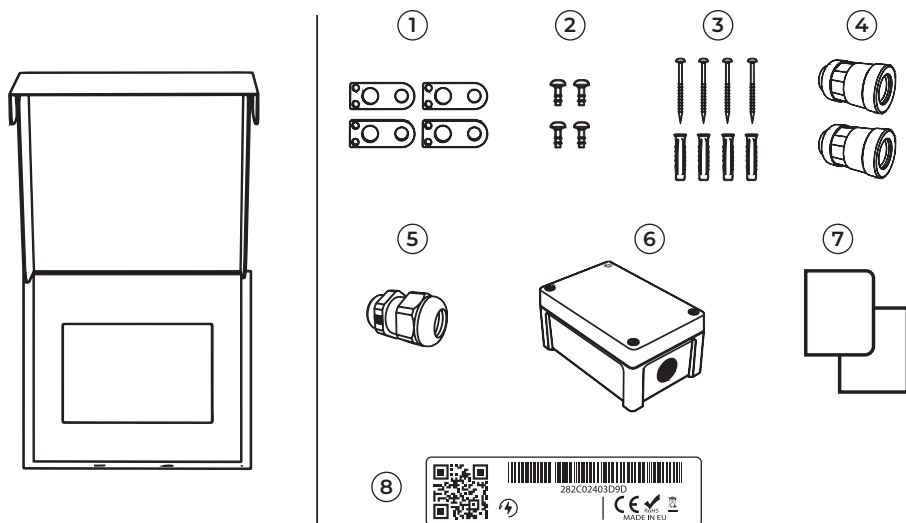

The **easyCounter** package contains:

- ① 4 wall fastening lug for wall mounting
- ② 4 screws for fixing the brackets to the box
- ③ 4 screws and 4 fixing plugs for wall mounting
- ④ 2 pipe-box connectors Ø 25 mm<sup>2</sup>
- ⑤ 1 cable gland Ø 25 mm<sup>2</sup>
- ⑥ **easyCounter**
- ⑦ Manual and product certificate
- ⑧ Sticker for connection to smartphone



**Do not stack loads on the box containing easyCounter and pay attention to the signs and specific instructions on the package.**

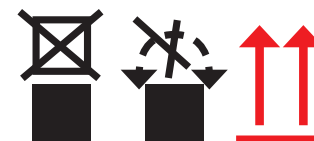

**The material supplied is suitable for connection to the electrical system powering easyCounter. If the installer should decide to use other solutions, they must use alternative materials at their own expense, taking responsibility for it.**

When the box is opened, check that the various parts of **easyCounter** do not show signs of physical damage caused by knocks, lacerations or abrasions. If damage is detected, installation must be interrupted immediately and the type of damage reported to the seller. If necessary, contact Assistance (see Chapter 9).

When the box is opened, the parts must be cleaned, removing any dust, PVC residues or portions of adhesive tape. **easyCounter** must only be removed from the box when everything has been prepared for the installation and must be taken manually near to the wall chosen for installation.

#### 4.4. Finding the correct electrical line

If **easyWallbox** has already been installed in Power Upgrade mode, **easyCounter** must be installed on the electricity line for **easyWallbox**.

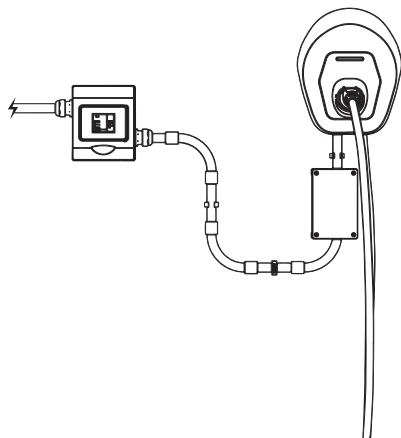

If **easyWallbox** has been installed in Plug & Play mode, **easyCounter** must be installed on the electrical line powering the socket for the connection of **easyWallbox**.

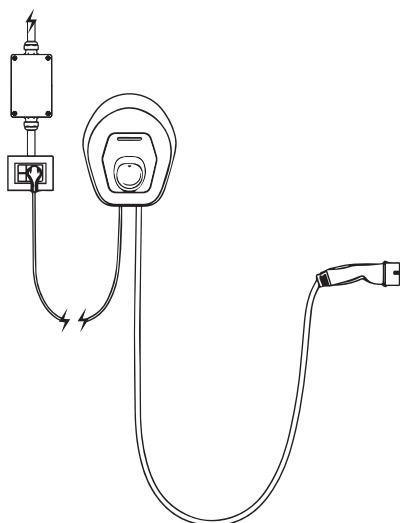

If **easyCounter** is installed for **easyWallbox** in Plug & Play mode, the chosen socket must only be used for **easyWallbox**.  
**WARNING: Before connecting easyWallbox to the electricity network, see its manuals.**

#### 4.5. Wall mounting

- ① Drill
- ② Pencil
- ③ Screwdriver
- ④ Hammer
- ⑤ Spirit level
- ⑥ Measuring tape

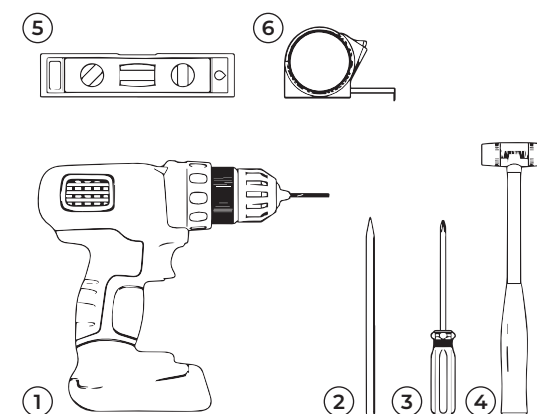

**Tools not included**

Free2Move eSolutions declines any liability for damage to persons or things that may arise from the use of such tools. We advise contacting Assistance for any question or doubt on the use of **easyWallbox** (see Chapter 9).



**Risk of electric shock.**  
**Before starting installation, ensure that easyCounter is not connected to any power supply. Any installation, maintenance or dismantling operation must only be carried out with the power disconnected.**

### Wall-mounting height for easyCounter

**easyCounter** must be mounted at least 50 cm from the floor; it can be installed near to **easyWallbox** in a vertical position.

When choosing the wall for the installation of **easyCounter**, the distances from the electrical switchboard, **easyWallbox** and the floor must be taken into account.

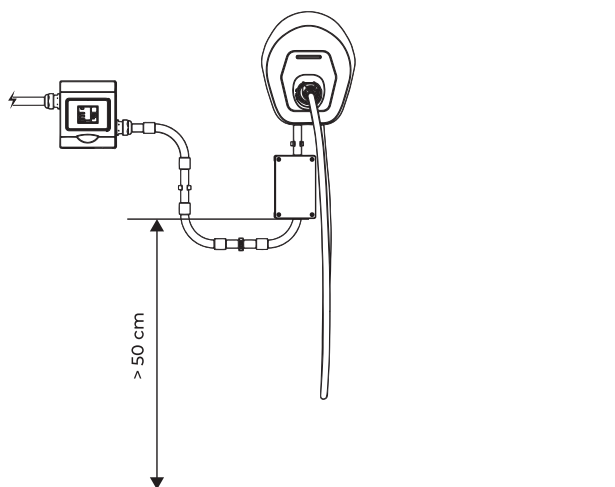

The image is only for illustration and is a non-binding example of installation.



**The installation height of easyCounter must be defined by the installer in accordance with local installation laws concerning the ultimate installation area (for example, basement garage).**

### Follow the steps below:

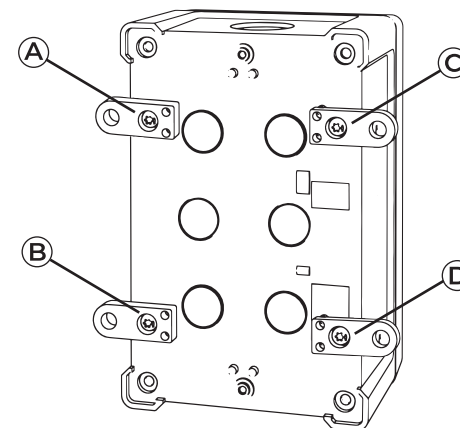

1. Position the wall brackets supplied in the kit and fix them in positions A, B, C and D with the appropriate screws.

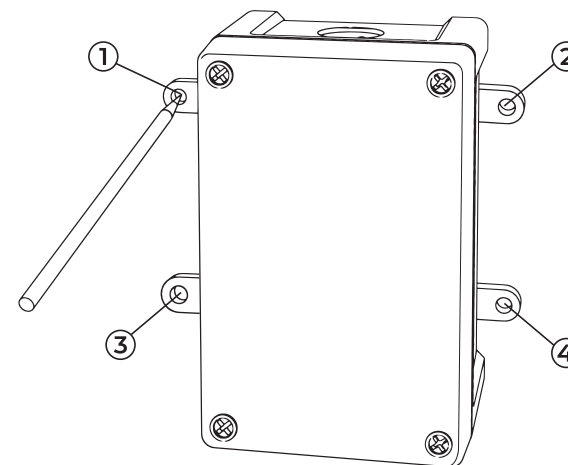

2. Place **easyCounter** in the desired position and mark the points for the holes on the wall.

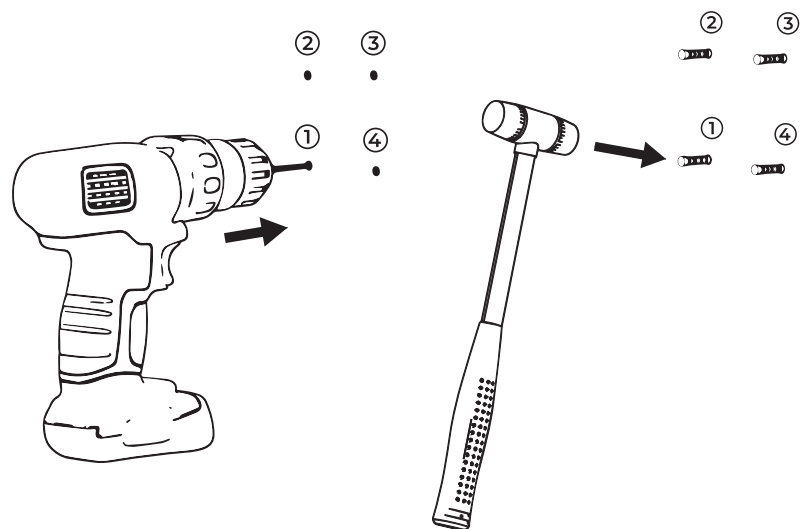

3. Make the holes in the wall with a drill.

4. Put the dowels into the holes using a hammer.

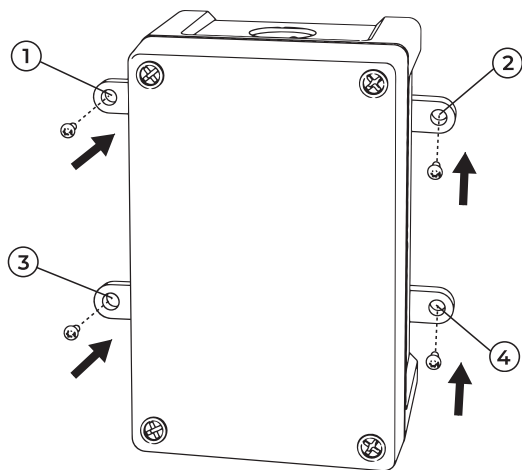

5. Position **easyCounter** in correspondence with the holes and fix it to the wall using the screws supplied.

#### 4.6. Connecting the power supply cables



Once **easyCounter** is open, wiring and installation should be carried out without removing the components from their housing.

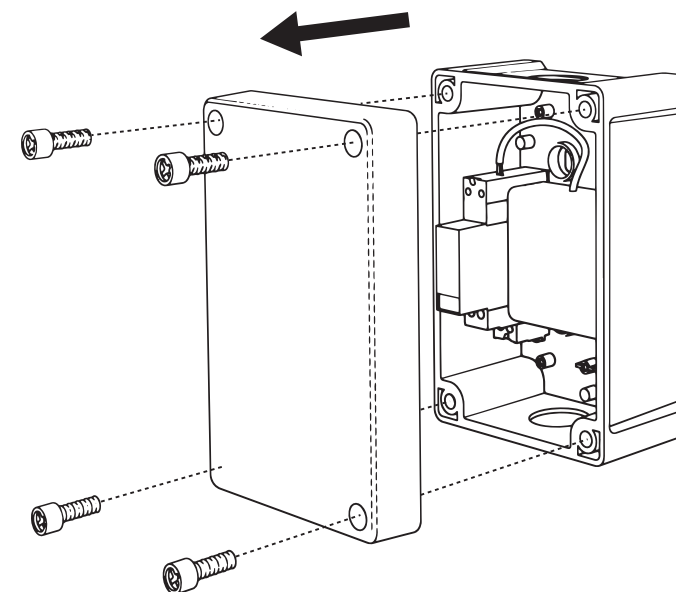

1. Remove the front cover of **easyCounter** by loosening the 4 screws.
2. Prepare the internal energy meter for wiring by loosening the screws on the terminals indicated with **Ni**, **No**, **Li**, and **Lo**.

#### 4.6.1. SITUATION A: Wiring between easyCounter and easyWallbox installed in Power Upgrade mode

If **easyWallbox** has been installed in **Power Upgrade mode**, carry out the following steps. Otherwise see Chapter 4.6.2.



We advise using flexible cables with a maximum section of 6 mm<sup>2</sup>. We suggest using a corrugated conduit or spiral sleeve with a section of 25 mm<sup>2</sup>.

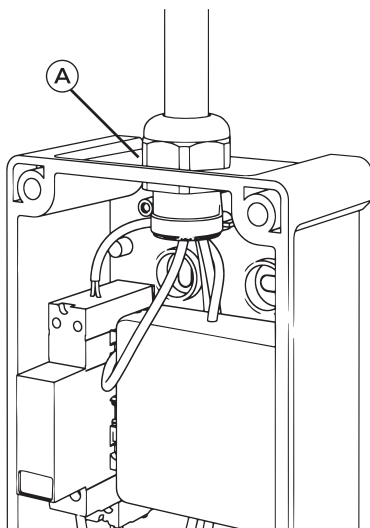

1. Choose either the pipe-box connector or cable-gland supplied, install it at position A and insert the power supply cables.

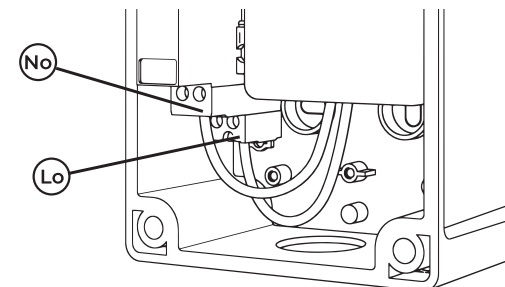

2. Connect the **easyWallbox** line cable (L) to the terminal indicated with ↓ **Lo** and tighten the screw checking that the wiring has been done correctly. Connect the **easyWallbox** neutral wire (N) to the terminal indicated with ↓ **No** and tighten the screw checking that the wiring has been done correctly.

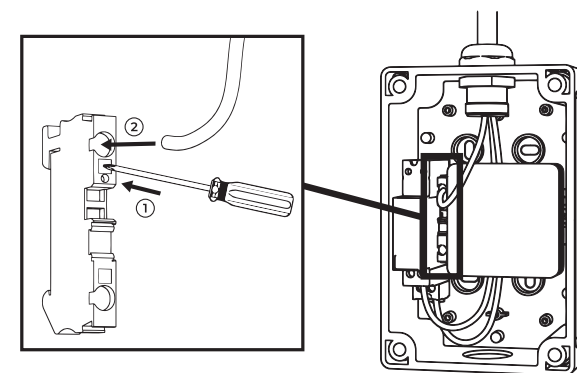

3. Connect the **easyWallbox** earth wire by pressing on the spring connection of the earth terminal with a screwdriver checking that wiring has been done correctly.



Installation with cables and cable-glands can only be made if it is not dangerous and, in any case, in compliance with local and international regulations.

#### 4.6.2. SITUATION B: Wiring between easyCounter and easyWallbox installed in Plug & Play mode

If **easyWallbox** has been installed in Plug & Play mode, carry out the following steps:

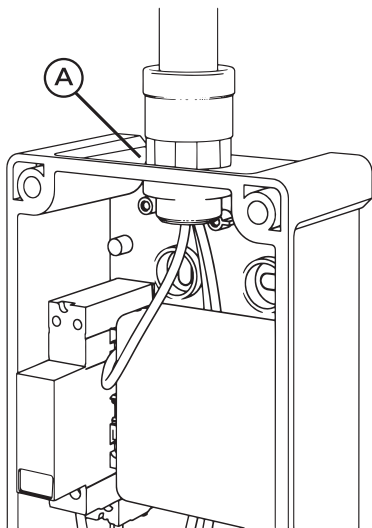

1. Choose the pipe-box connector supplied, install it at position A and insert the specific power supply cables of the chosen socket.

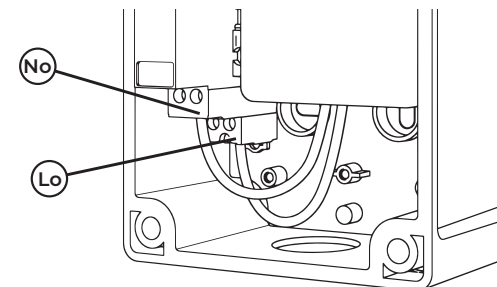

2. Connect line cable (L) of the domestic system to the terminal indicated with ↓ **Lo** and tighten the screw checking that the wiring has been done correctly.  
Connect the neutral wire (N) of the domestic system on the side of the Schuko plug supplying the **easyWallbox** to the terminal indicated with ↓ **No** and tighten the screw checking that the wiring has been done correctly.

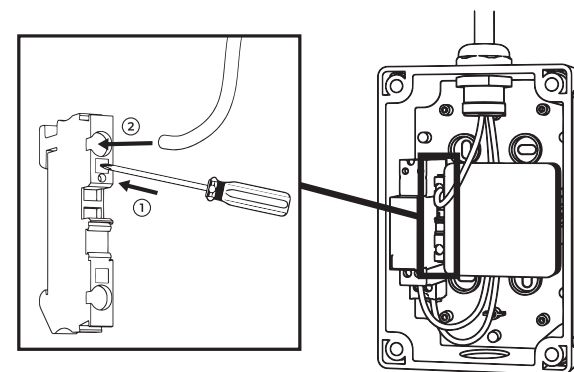

3. Connect the **easyWallbox** earth wire by pressing on the spring connection of the earth terminal with a screwdriver checking that wiring has been done correctly.

#### 4.6.3. Connection to the electrical system



##### Risk of electric shock

Before starting installation, ensure that easyWallbox is not connected to any power supply. Any installation, maintenance or dismantling operation must only be carried out with the power disconnected.



We advise using flexible cables with a maximum section of 6 mm<sup>2</sup>. We suggest using a cable duct with a section of 25 mm<sup>2</sup>.

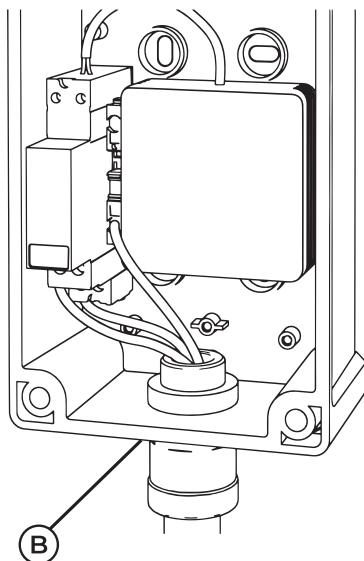

1. Use the pipe-box connector supplied, install it in position B and insert the power supply cables of the domestic system. Shorten the connection wires to the appropriate length (avoid leaving too much cable margin).

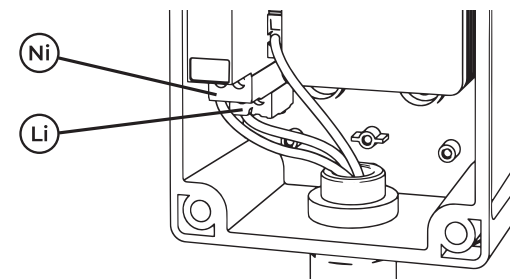

2. Connect the line cable (L) of the domestic system to the terminal indicated with **Li** and tighten the screw checking that the wiring has been done correctly.  
Connect the neutral wire (N) of the domestic system to the terminal indicated with **Ni** and tighten the screw checking that the wiring has been done correctly.

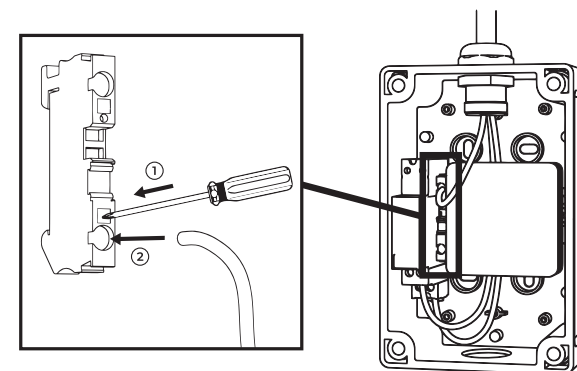

3. Connect the earth wire of the domestic system by pressing on the spring connection of the earth terminal with a screwdriver checking that the wiring has been done correctly.



**Incorrect installation may cause danger such as serious injury or death. Free2Move eSolutions does not assume any liability for damage caused by non-compliant installation of the device. The qualified personnel are responsible for the technical, state of the art completion of the installation respecting the regulations in force.**

#### 4.6.4. Activating the Bluetooth gateway

Once the electrical connection has been completed, the device must be activated by carrying out the following steps:

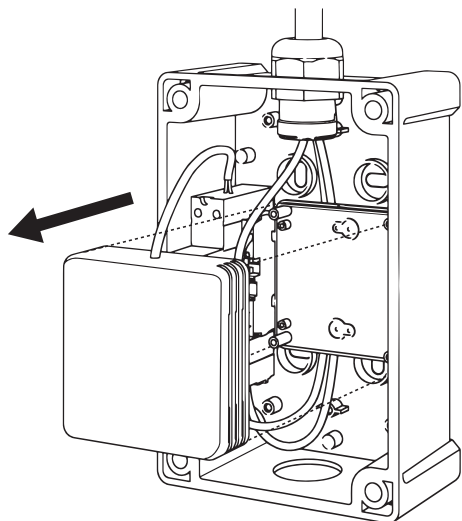

1. Remove the gateway cover by extracting it from its position.



Be careful not to damage the connection cable between the Bluetooth gateway and the meter.

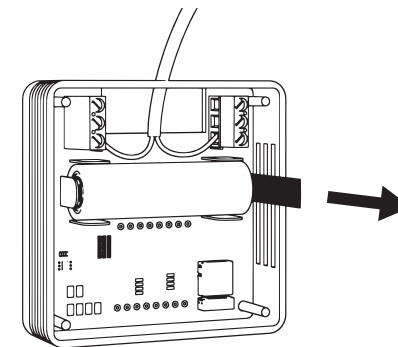

2. Remove the tab on the positive pole of the battery. Once removed, the gateway will start automatically.

If powered, the gateway stays operational even if there are no specific indications.

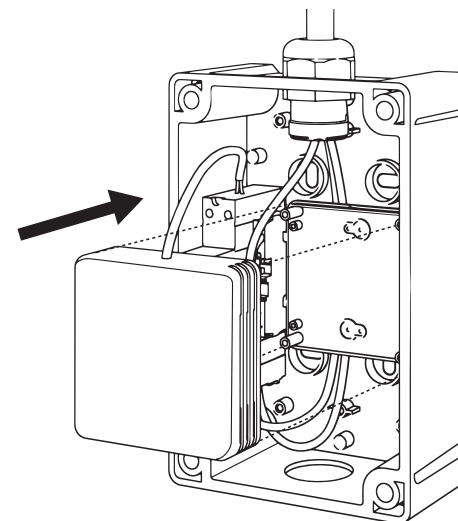

3. Reposition the gateway cover ensuring that the plastic supports are not damaged.



#### 4.6.5. Re-assembling the device

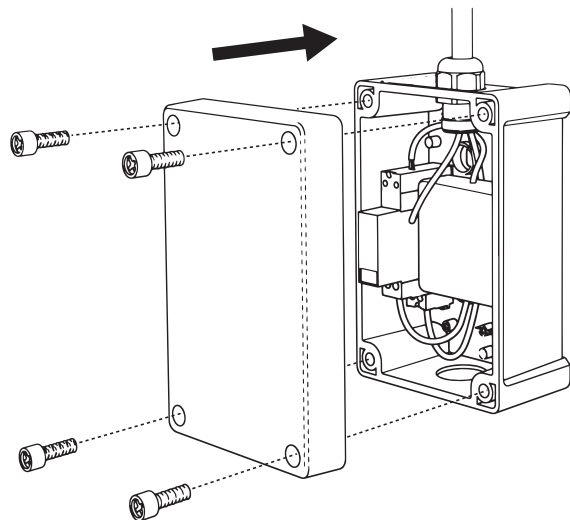

1. Reposition the front cover of **easyCounter** and tighten the four screws checking their tightness.
2. Once wall installation has been completed, **easyCounter** can be powered.



Before connection to the electrical network, ensure that **easyCounter** is correctly installed with a suitable earthing connection and in compliance with local and international standards. Also ensure that **easyWallbox** has been correctly installed, as indicated in the relative manuals. **Free2Move eSolutions does not assume any liability for damage caused by non-compliant installation of the device. The qualified personnel are responsible for the technical, state of the art completion of the installation respecting the regulations in force.**

## 5. FIRST START

### 5.1. Turning on easyCounter

The device does not have start/stop buttons. Once installed, it is ready to charge when there are the following conditions:

- correct installation, carried out following the instructions in this manual
- regular status of the device.



**Danger of electric shock when the device is damaged. Use of a damaged device may generate electrical discharges.**

If the device is damaged, follow the instructions below precisely to avoid dangerous situations, with the resulting damage to persons or things:

- avoid using the damaged device
- clearly indicate the damaged device so that other people will not use it
- call qualified personnel promptly so that the device can be taken out of service.

## 5.2. Connection via the My easyWallbox app (specifically for the end-user)



My **easyWallbox** is a dedicated app for smartphones available from both Google Play® and App Store®. It can be used via Bluetooth connection for both monitoring and setting **easyWallbox** and for the acquisition and transmission of the consumption recorded by **easyCounter**.

After downloading the app, opening it and connecting to **easyWallbox**, go to the dedicated section on **easyCounter** and follow the instructions shown on the screen, logging in to your account.

When **easyCounter** is used for the first time, it must be associated with your smartphone. To do this, login to your account and frame the QR code printed on the sticker supplied with the installation kit with your smartphone, as indicated by the app.



If you lose the sticker, a copy of it can be found applied to the side of the Bluetooth gateway.

## 5.3. Reading consumption data

To read the consumption data:

1. Approach the **easyCounter** with Bluetooth activated on your smartphone.
2. Access the My **easyWallbox** app. The data will be read automatically.

At the end of the procedure, see the section on **easyCounter**. Here, in confirmation of the operation, the date and time of the last reading of the consumption data and the last transmission to the eCommerce platform can be checked.

To ensure the service operates correctly, the data should be read monthly, as indicated in the subscription terms of the service, following the instructions given in the app.



**easyCounter cannot be connected to more than one smartphone at the same time.**

## 6. MAINTENANCE



**Before starting any maintenance operation on easyCounter, check that it has been disconnected from the power supply.**



**The greatest attention is always necessary during maintenance so that personal injury and damage to the internal components of the product can be avoided.**

The perfect operation and life of **easyCounter** depend on the periodic checks and maintenance the apparatus undergoes. These are some examples of damage that **easyCounter** may suffer from:

- damage to the case
- damage to components
- accidental removal of components.



**A defective or damaged device must not be used under any circumstances. Any defects must be rectified immediately by qualified personnel.**



**Danger of electric shock when the device is damaged. Use of a damaged device may generate electrical discharges.**

If the device is damaged, follow the instructions below precisely to avoid dangerous situations, with the resulting damage to persons or things:

- avoid using the damaged device
- clearly indicate the damaged device so that other people will not use it
- call qualified personnel promptly so that the device can be repaired or, if irreparably damaged, taken out of service.

### 6.1. Replacing the gateway battery

**easyCounter** requires the periodic replacement of the battery. If the residual battery charge falls below 10%, a notification via the My **easyWallbox** app on their smartphone advises the user to replace the battery. In these circumstances, use of qualified personnel is not necessary but the user must follow the steps below:



**Ensure that the power supply to both easyWallbox and easyCounter has been turned off.**

1. Disconnect the electricity on the dedicated line for **easyCounter** and **easyWallbox**.

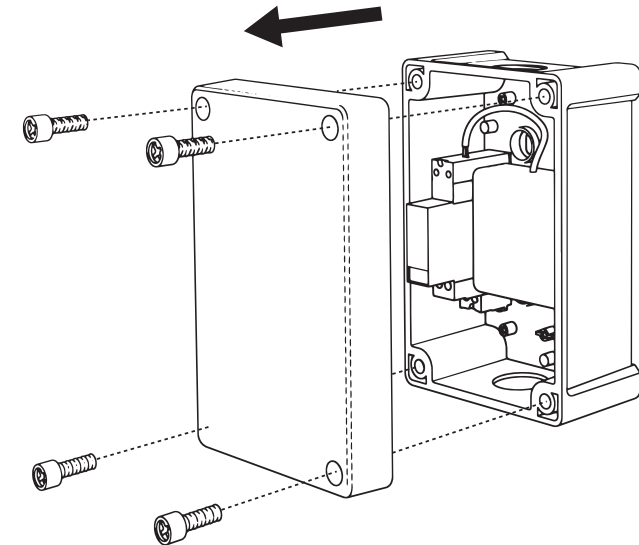

2. Remove the front cover of **easyCounter** by loosening the 4 screws.

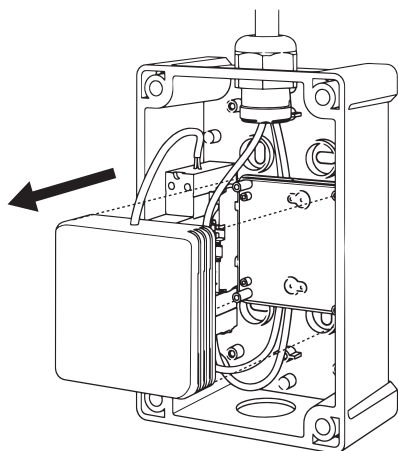

3. Remove the gateway cover cautiously.



Ensure that the connection cable between the Bluetooth gateway and meter is not damaged.

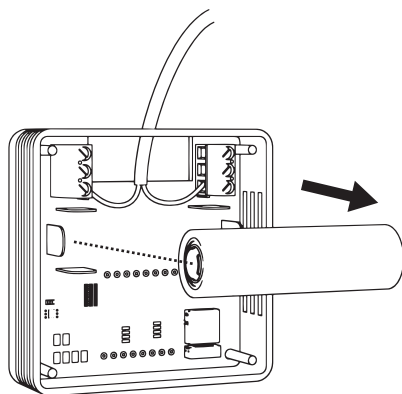

4. Remove the battery carefully and replace it with an equivalent one (AA 3.6 V).

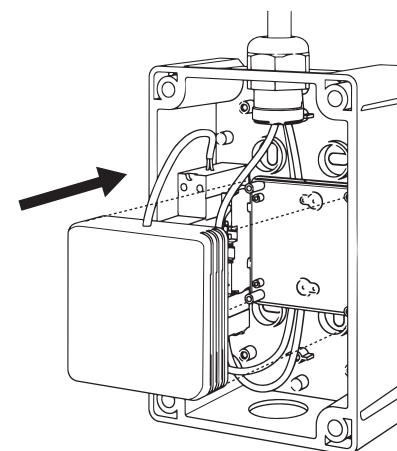

5. Reposition the gateway cover.

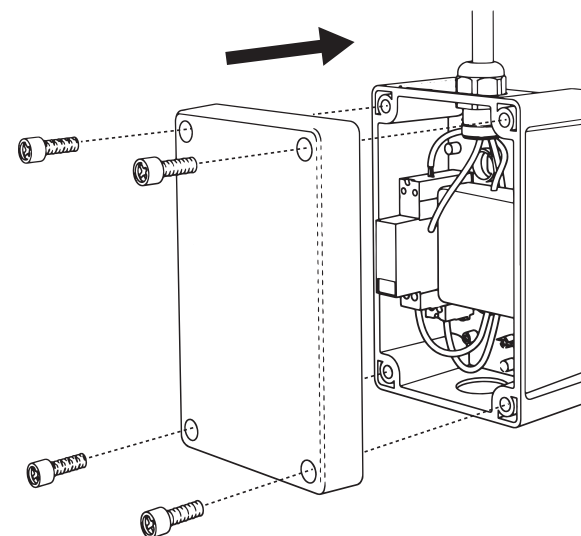

6. Return the front cover of **easyCounter** to its position by once again tightening the four screws to the right degree.

7. Restore the power supply to **easyWallbox**.

## 7. DISMANTLING AND STORAGE

Once **easyCounter** has reached the end of its technical and operational life, it must be deactivated or taken out of service.

### 7.1. Disconnection from the power supply



**Risk of electric shock.**

**Before starting to dismantle the device, ensure that **easyWallbox** is not connected to any power supply. Any installation, maintenance and dismantling operation should only be done when disconnected from the power supply.**

**Qualified personnel must be used to dismantle **easyCounter**.**

### 7.2. Removal of the device from the wall

Proceed as follows to remove **easyCounter** from the wall where it is installed:

1. Turn off the power supply on the dedicated line for **easyCounter** and **easyWallbox**.

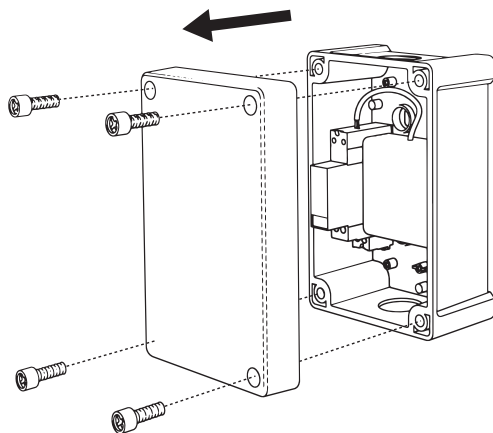

2. Remove the front cover of **easyCounter** by unscrewing the 4 screws.

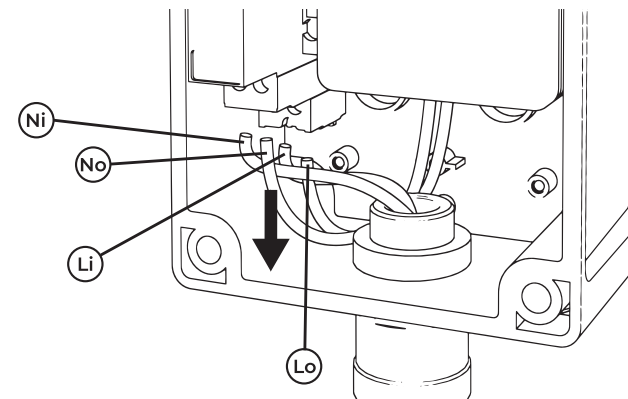

3. Loosen the screws on the terminals that the phase and neutral cables of the energy meter are attached to and remove them from the housing.

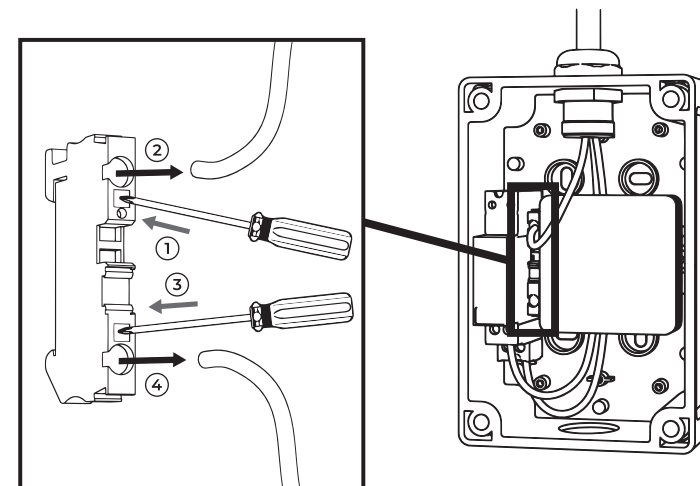

4. Disconnect the earth wire of **easyWallbox** and the domestic system by pressing on the spring connection of the earth terminal with a screwdriver.

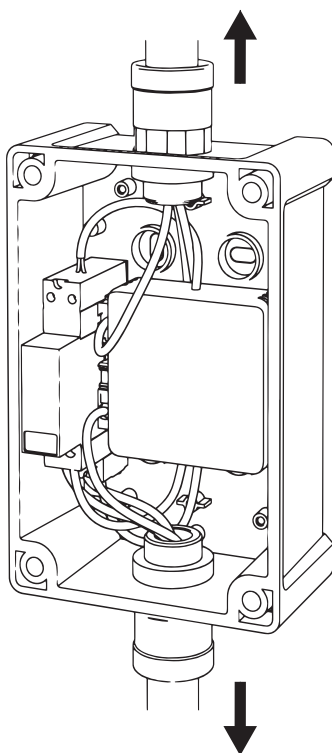

5. Loosen the connectors/cable-glands and remove the supply cable to **easyWallbox** and the domestic electrical system from its housing.

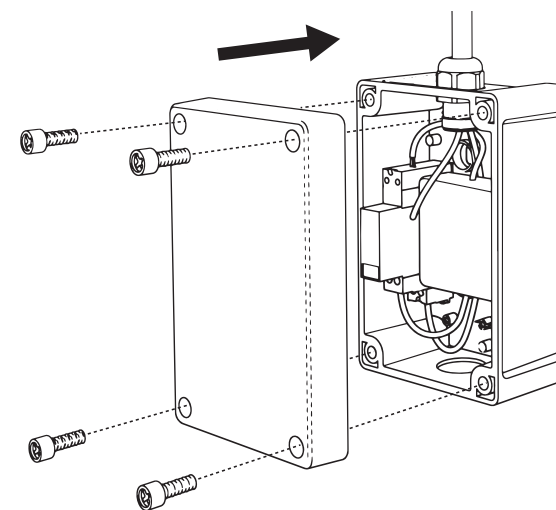

6. Reposition the front cover of **easyCounter** and tighten the 4 screws.

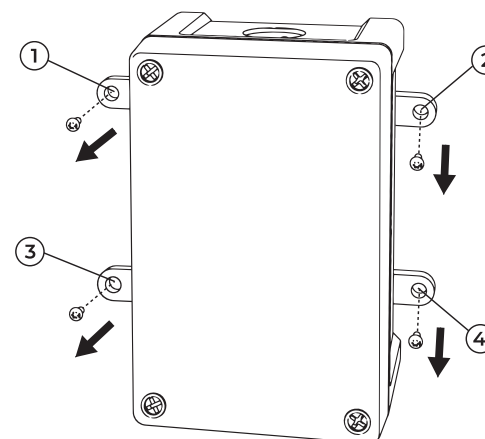

7. Loosen the screws fixing **easyCounter** to the wall.

### 7.3. Storage

If you want to dismantle **easyCounter** and keep it for future use, use the following precautions to maintain its operability:

- clean the device well before storing
- remove the gateway battery
- put the clean device into the original packaging or suitable clean and dry material
- follow the storage conditions:
  - the temperature of the place where the device is stored must be between -25°C and +40°C
  - the average temperature over 24 hrs must not exceed 35°C
  - the relative air humidity must not exceed 95% and condensation must not form.

## 8. DISPOSAL



### 8.1. Disposal of the packaging

Dispose of the packaging in an environmentally friendly manner. The materials used for the packaging of this product can be recycled and must be disposed of in compliance with the legislation in force in the country of use.

### 8.2. Taking out of service and disposal of easyCounter

This apparatus is certified in compliance with European Directive 2012/19/UE on used electric and electronic equipment (Waste Electric and Electronic Equipment - WEEE). The guidelines determine the framework for the return and recycling of used appliances as applicable throughout the EU. Further information about current disposal facilities can be obtained from local authorities.



**Electric and electronic waste (WEEE) must be treated and disposed of in compliance with current legislation, separately from normal household waste.**

## 9. ASSISTANCE

If there are any questions about the installation of **easyCounter**, please contact an authorised assistance centre.

The assistance centres available to customers can be found at [www.easywallbox.eu](http://www.easywallbox.eu). If there are any questions about the use of **easyCounter**, please contact an authorised assistance centre. Free2Move eSolutions will provide assistance in the local language (Italian) via a land-line.

Land-line: 8:00 am-8:00 pm, Monday to Saturday.

If you contact Free2Move eSolutions assistance, please have the following information available, as shown in Chapter 3.2:

- name of the model;
- serial number.

## **DISCLAIMER**

The information in this manual belongs to Free2Move eSolutions S.p.A. and cannot be wholly or partly reproduced.

The Italian version of this manual is the original. Instructions in other languages are translations of the original manual.

Free2Move eSolutions will not be held responsible for any damage that may directly or indirectly result to people, things or animals due to the failure to comply with all the prescriptions indicated in this Manual and the warnings regarding the installation, use and maintenance of the easyCounter.

Free2Move eSolutions reserves all rights in this document, the article, and the illustrations it contains. Any whole or part reproduction, disclosure to third parties or use of its contents is prohibited without the prior written consent of Free2Move eSolutions.

The product is covered by the legal guarantee of compliance of goods set out by the Consumer Code, which can be viewed on [www.easywallbox.eu](http://www.easywallbox.eu).

© Copyright 2021 Free2Move eSolutions S.p.A. V.062021

All rights reserved

**[www.easywallbox.eu](http://www.easywallbox.eu)**